

Double Direction Thrust Ball Bearings

$d_2 = 10$ to 140 mm

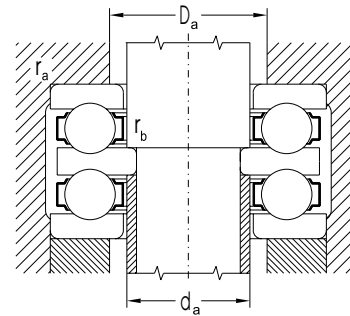
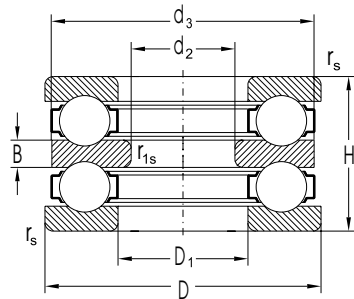

Dimensions								Basic Load Rating		Limiting Speed for Lubrication with		Bearing Designation	Abutment and Fillet Dimensions					Weight ~	Minimum Axial Load Factor
d_2	D	d_3	D_1	H	B	r_s min	r_{1s} min	C_a	C_{oa}	Grease	Oil		d_2	d_a max	D_a max	r_a max	r_b max		
mm								kN		min ⁻¹			mm					kg	
10	32	32.0	17	22	5	0.6	0.3	15.8	16.5	6000	7900	52202A	10	15	22	0.6	0.3	0.08	0.004
15	40	40.0	22	26	6	0.6	0.3	22.4	26.1	5000	6700	52204A	15	20	28	0.6	0.3	0.15	0.008
	60	60.0	27	45	11	1.0	0.6	55.2	55.2	3200	4200	52405A		25	39	1.0	0.6	0.63	0.035
20	47	47.0	27	28	7	0.6	0.3	27.6	36.2	4500	6000	52205A	20	25	34	0.6	0.3	0.23	0.015
	52	52.0	27	34	8	1.0	0.3	35.5	42.2	3800	5000	52305A		25	36	1.0	0.3	0.33	0.020
	70	70.0	32	52	12	1.0	0.6	72.2	81.0	2700	3500	52406A		30	46	1.0	0.6	1.00	0.085
25	52	52.0	32	29	7	0.6	0.3	29.3	43.8	4000	5300	52206A	25	30	39	0.6	0.3	0.27	0.018
	60	60.0	32	38	9	1.0	0.3	43.0	55.2	3300	4500	52306A		30	42	1.0	3.0	0.49	0.030
	80	80.0	37	59	14	1.1	0.6	87.4	100.0	2200	3000	52407A		35	53	1.0	0.6	1.44	0.120
30	62	62.0	37	34	8	1.0	0.3	39.1	58.4	3500	4700	52207A	30	35	46	1.0	0.3	0.42	0.032
	68	68.0	37	44	10	1.0	0.3	55.2	73.6	2800	3800	52307A		35	48	1.0	0.3	0.71	0.050
	68	68.0	42	36	9	1.0	0.6	43.8	70.8	3200	4200	52208A		40	51	1.0	0.6	0.54	0.047
	78	78.0	42	49	12	1.0	0.6	69.4	94.4	2700	3500	52308A		40	55	1.0	0.6	1.06	0.095
	90	90.0	42	65	15	1.1	0.6	112.0	133.0	2000	2700	52408ATNG		40	60	1.0	0.6	2.03	0.190
35	73	73.0	47	37	9	1.0	0.6	46.4	81.0	3000	4000	52209A	35	45	56	1.0	0.6	0.62	0.060
	85	85.0	47	52	12	1.0	0.6	79.4	117.0	2400	3200	52309A		45	61	1.0	0.6	1.29	0.130
	100	100.0	47	72	17	1.1	0.6	131.0	158.0	1900	2500	52409A		45	67	1.0	0.6	2.71	0.350
40	78	78.0	52	39	9	1.0	0.6	47.3	87.4	2800	3800	52210A	40	50	61	1.0	0.6	0.71	0.082
45	90	90.0	57	45	10	1.0	0.6	69.4	123.0	2500	3300	52211A	45	55	69	1.0	0.6	1.12	0.110
	105	105.0	57	64	15	1.1	0.6	91.5	174.0	1900	2500	52311A		55	75	1.0	0.6	2.51	0.270
	120	120.0	57	87	20	1.5	0.6	156.0	251.0	1600	2100	52411A		55	81	1.5	0.6	4.70	0.650
50	110	110.0	62	64	15	1.1	0.6	95.0	192.0	1900	2500	52312A	50	60	80	1.0	0.6	2.68	0.350
55	100	100.0	67	47	10	1.0	0.6	75.0	150.0	2400	3200	52213A	55	65	79	1.0	0.6	1.36	0.170
	115	115.0	67	65	15	1.1	0.6	128.0	211.0	1800	2400	52313A		65	85	1.0	0.6	2.90	0.450
	105	105.0	72	47	10	1.0	1.0	76.4	162.0	2200	3000	52214A		70	84	1.0	0.6	1.48	0.210
	125	125.0	72	72	16	1.1	1.0	147.0	251.0	1700	2200	52314A		70	92	1.0	1.0	3.90	0.540
	150	150.0	73	107	24	2.0	1.0	251.0	369.0	1200	1600	52414A		70	102	2.0	1.0	9.71	1.600
60	110	110.0	77	47	10	1.0	1.0	77.9	171.0	2200	3000	52215A	60	75	89	1.0	1.0	1.57	0.270
	135	135.0	77	79	18	1.5	1.0	185.0	310.0	1600	2100	52315A		75	99	1.5	1.0	4.83	0.760
	65	115	115.0	82	48	10	1.0	1.0	79.4	181.0	2000	2700		52216A	65	80	95	1.0	1.0
170	170.0	83	120	27	2.1	1.0	316.0	482.0	890	1200	52416	80	117	2.0		1.0	14.00	2.700	
70	125	125.0	88	55	12	1.0	1.0	96.2	215.0	1900	2500	52217A	70	85	101	1.0	1.0	2.34	0.430
	150	150.0	88	87	19	1.5	1.0	224.0	376.0	1300	1800	52317A		85	111	1.5	1.0	6.43	1.200
	190	189.5	93	135	30	2.1	1.1	383.0	619.0	790	1060	52418		90	131	2.0	1.0	19.60	4.100
75	155	155.0	93	88	19	1.5	1.0	233.0	406.0	1100	1500	52318	75	90	116	1.5	1.0	6.60	1.500
100	210	209.5	123	123	27	2.1	1.1	348.0	708.0	790	1060	52324	100	120	157	2.0	1.0	17.20	4.100
140	225	224.5	163	90	20	1.5	1.1	276.0	722.0	890	1200	52232	140	160	186	1.5	1.0	12.20	3.200