

Spherical Roller Thrust Bearings

d = 60 to 180 mm

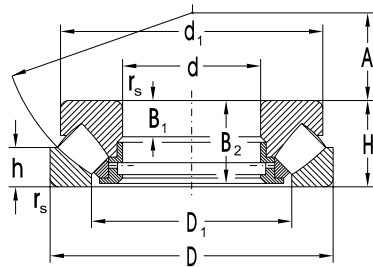

M, EM

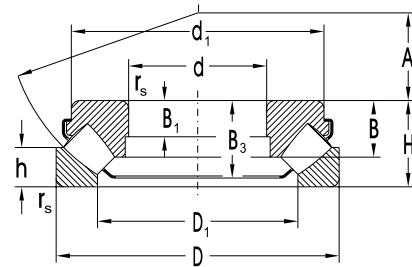

J, EJ

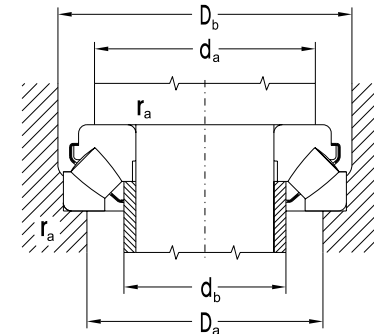
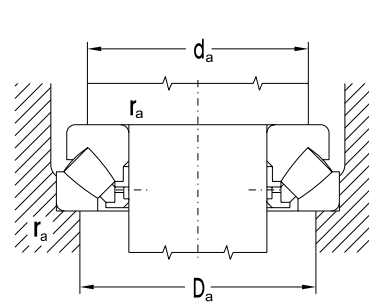

Dimensions												Basic Load Rating		Limiting Speed for Lubrication with Oil	Bearing Designation						Abutment and Fillet Dimensions					Weight		Minimum Axial Load Factor
d	D	H	d ₁	D ₁	B	B ₁	B ₂	B ₃	h	A	r _s	C _{da}	C _{oa}		min ⁻¹	d	d _a min	d _b max	D _a max	D _b min	r _a max	~M	J					
mm												kN			mm						kg							
60	130	42	118	88.0	28.0	15.0	39.5	35.5	20	38	1.5	287	809	2400	29412M	29412J	60	90	67	109	140	1.5	2.60	2.47	0.080			
65	140	45	128	96.5	30.0	16.0	42.5	38.0	21	42	2.0	340	973	2200	29413M	29413J	65	100	74	118	150	2.0	3.30	3.22	0.100			
70	150	48	137	102.0	32.0	17.0	45.5	42.0	23	44	2.0	371	1071	2000	29414M	29414J	70	105	79	126	160	2.0	4.00	3.98	0.140			
75	160	51	146	109.0	34.5	18.0	48.0	44.5	24	47	2.0	429	1254	2000	29415M	29415J	75	115	84	134	170	2.0	4.90	4.74	0.180			
80	170	54	155	116.0	36.0	19.0	51.0	46.5	24	50	2.1	464	1367	1900	29416M	29416J	80	120	88	141	180	2.0	5.80	5.57	0.250			
85	180	58	164	125.0	38.0	21.0	55.0	49.0	28	54	2.1	527	1570	1800	29417M	29417J	85	130	97	153	190	2.0	6.90	6.64	0.300			
90	190	60	174	130.0		22.0	57.0		29	56	2.1	578	1784	1700	29418M		90	135		161		2.0	8.10		0.370			
100	210	67	193	144.5		24.0	64.0		32	62	3.0	705	2127	1500	29420M		100	150		178		2.5	11.80		0.600			
110	190	48	176	143.0	31.0	16.0	45.5	42.0	23	64	2.0	442	1415	1600	29322M	29322J	110	145	117	165	200	2.0	5.50	5.40	0.250			
	190	48	176	143.0	31.0	16.0		42.0	23	64	2.0	570	1760	1800		29322EJ		145	117	165	200	2.0		5.40	0.250			
	230	73	212	160.0		26.0	69.0		35	69	3.0	817	2601	1400	29422M			165		196		2.5	14.50		0.800			
120	210	54	194	157.5		18.0	51.0		26	70	2.1	560	1831	1400	29324M		120	160		184		2.0	7.60		0.360			
	250	78	229	172.0		29.0	74.0		37	74	4.0	934	2996	1300	29424M			180		212		3.0	18.10		1.100			
130	225	58	205	170.0	37.0	19.0	55.0	50.5	28	76	2.1	628	2071	1300	29326M	29326J	130	170	140	198	235	2.0	9.30	8.65	0.520			
	270	85	247	188.0	55.5	31.0	81.0	72.0	41	81	4.0	1086	3538	1200	29426M	29426J		195	148	229	280	3.0	22.50	21.80	1.600			
140	240	60	219	183.0		20.0	57.0		29	82	2.1	675	2311	1300	29328M		140	185		211		2.0	11.00		0.680			
	280	85	257	197.5		31.0	81.0		41	86	4.0	1130	3750	1200	29428M			205		239		3.0	24.20		2.000			
150	250	60	229	193.0		20.0	57.0		29	87	2.1	697	2425	1200	29330M		150	195		222		2.0	11.50		0.900			
	300	90	276	211.5		32.0	86.0		44	92	4.0	1276	4270	1100	29430M			220		257		3.0	29.40		2.500			
160	270	67	248	207.0		23.0	64.0		32	92	3.0	807	2812	1100	29332M		160	210		239		2.5	15.20		1.100			
	320	95	306	226.0		34.0	91.0		45	99	5.0	1461	4806	1000	29432M			230		274		4.0	35.50		3.000			
170	280	67	258	215.0		23.0	64.0		32	96	3.0	833	2948	1100	29334M		170	220		248		2.5	16.00		1.400			
	340	103	324	240.0		37.0	99.0		50	104	5.0	1624	5376	940	29434M			245		291		4.0	43.70		3.800			
180	300	73	277	231.0		25.0	69.0		35	103	3.0	984	3525	1000	29336M		180	235		266		2.5	20.30		1.600			
	360	109	342	255.0		39.0	105.0		52	110	5.0	1803	6021	890	29436M			260		307		4.0	52.00		4.700			

Spherical Roller Thrust Bearings

d = 190 to 380 mm

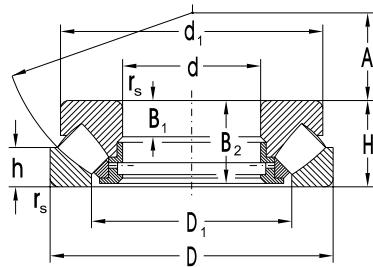

M, EM

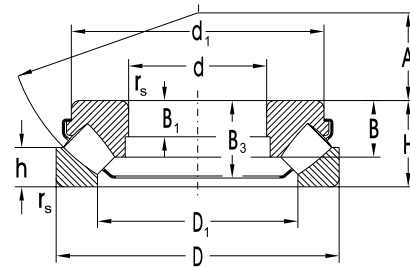

J, EJ

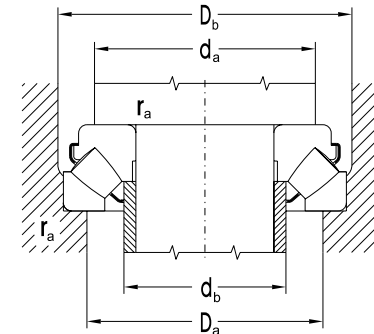
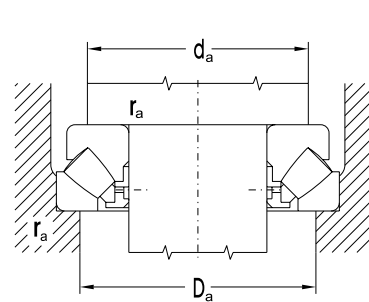

Dimensions													Basic Load Rating		Limiting Speed for Lubrication with Oil	Bearing Designation	Abutment and Fillet Dimensions						Weight		Minimum Axial Load Factor
d	D	H	d ₁	D ₁	B	B ₁	B ₂	B ₃	h	A	r _s min	C _{da} Dynamic	C _{oa} Static	d			d _a min	d _b max	D _b min	D _a max	r _a max	~ M	J		
mm													kN		min ⁻¹		mm						kg		
190	320	78	308	246.0		27.0	74.0		38	110	4.0	1115	4013	940	29338M	190	250		283	3.0	24.80	2.000			
	380	115	360	270.0		41.0	111.0		55	117	5.0	1960	6607	840		29438M	275		325	4.0	60.00	5.700			
200	340	85	325	261.0		29.0	81.0		41	116	4.0	1299	4740	890	29340M	200	265		300	3.0	30.80	2.400			
	340	85	325	261.0	54.5	29.0		77.4	41	116	4.0	1340	4969	890		29340J	265	224	350	300	3.0	28.9	2.400		
	400	122	380	284.0		43.0	117.0		59	122	5.0	2208	7508	790			29440M	290		343	4.0	69.00	6.800		
220	360	85	345	280.0		29.0	81.0		41	125	4.0	1340	7969	840	29344M	220	285		320	3.0	32.80	3.100			
	420	122	400	305.0		43.0	117.0		58	132	6.0	2257	7968	750	29444M	310		364	5.0	74.00	8.000				
240	340	60	330	283.0		19.0	57.0		30	130	2.1	770	3450	890	29248M	240	285		311	2.0	16.70	1.300			
	380	85	365	300.0		29.0	81.0		41	135	4.0	1341	5185	790	29348M	300		340	3.0	35.30	4.400				
	440	122	420	321.0		43.0	117.0		59	142	6.0	2340	8416	750	29448M	330		383	5.0	79.00	10.000				
260	360	60	350	302.0		19.0	57.0		30	139	2.1	801	3654	890	29252M	260	305		331	2.0	18.50	1.500			
	420	95	405	325.0		32.0	91.0		45	148	5.0	1777	6820	750	29352M	330		374	3.0	48.50	5.700				
	480	132	460	346.0		48.0	127.0		64	154	6.0	2730	9871	670	29452M	360		419	5.0	105.00	13.000				
280	380	60	370	323.0		19.0	57.0		30	150	2.1	847	3952	840	29256M	280	325		351	2.0	19.50	1.700			
	440	95	423	345.0		32.0	91.0		46	158	5.0	1778	7103	710	29356M	350		394	4.0	52.50	7.000				
	520	145	495	380.0		52.0	140.0		68	166	6.0	3227	11844	630	29456M	390		453	5.0	132.00	18.000				
300	420	73	405	355.0		21.0	69.0		38	162	3.0	1025	4665	750	29260M	300	355		386	2.5	30.50	2.600			
	480	109	460	375.0		37.0	105.0		50	168	5.0	2182	8504	630	29360M	380		429	4.0	74.00	8.500				
	540	145	515	398.0		52.0	140.0		70	175	6.0	3217	11854	600	29460M	410		471	5.0	140.00	20.000				
320	440	73	430	375.0		21.0	69.0		38	172	3.0	1065	4925	710	29264M	320	375		406	2.5	32.90	2.800			
	500	109	482	395.0		37.0	105.0		53	180	5.0	2183	8854	630	29364M	400		449	4.0	77.00	10.000				
	580	155	555	430.0		55.0	149.0		75	191	7.5	3889	14694	560	29464M	435		507	6.0	175.00	28.000				
340	540	122	520	424.0		41.0	117.0		59	192	5.0	2644	10554	560	29368M	340	430		484	4.0	103.00	14.000			
	620	170	590	452.0		61.0	164.0		82	201	7.5	4346	16413	500	29468M	465		451	6.0	218.00	34.000				
360	500	85	485	420.0		25.0	81.0		44	194	4.0	1402	6596	630	29272M	360	420		461	3.0	51.80	4.900			
	560	122	540	444.0		41.0	117.0		59	202	5.0	2654	11031	560	29372M	450		504	4.0	107.00	15.000				
380	520	85	505	440.0		27.0	81.0		42	202	4.0	1545	7511	600	29276M	380	440		480	3.0	52.80	6.200			
	670	175	640	510.0		63.0	168.0		85	222	7.5	4600	18300	470	29476M	510		587	6.0	254.00	44.000				
	670	175	640	510.0		63.0	168.0		85	222	7.5	4700	19100	470	29476EM	510		587	6.0	254.00	44.000				

Spherical Roller Thrust Bearings

d = 400 to 800 mm

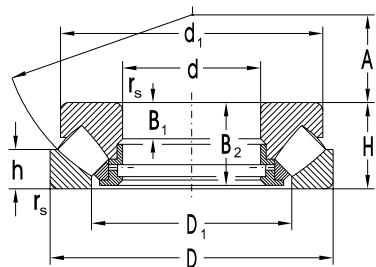

M, EM

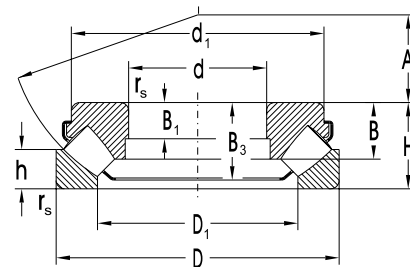

J, EJ

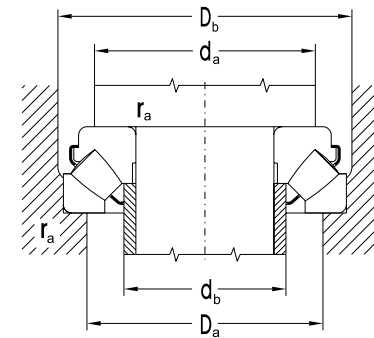
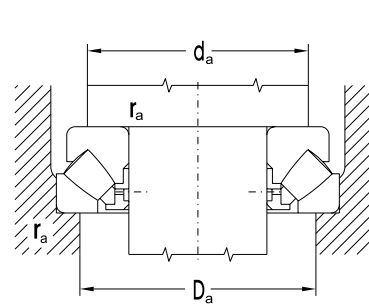

Dimensions										Basic Load Rating		Bearing Designation	Limiting Speed for Lubrication with Oil	Abutment and Fillet Dimensions				Weight ~	Minimum Axial Load Factor
d	D	H	d ₁	D ₁	B ₁	B ₂	h	A	r _s min	C _a Dynamic	C _{0a} Static			d	d _a min	D _a max	r _a max		
mm										kN			min ⁻¹	mm				kg	
400	540	85	526	460.0	27.0	81.0	42	212	4.0	1602	7899	29280M	600	400	460	500	3.0	55.30	7.000
	620	132	596	494.0	44.0	127.0	64	225	6.0	2573	11055	29380M	500	498	557	5.0	150.00	24.000	
420	650	140	626	520.0	48.0	135.0	68	235	6.0	3142	13146	29384M	450	420	523	5.0	170.00	26.00	
	730	185	700	546.0	67.0	178.0	89	244	7.5	5649	22400	29484M	420	560	643	6.0	323.00	64.000	
440	680	145	655	546.0	49.0	140.0	70	245	6.0	3072	13368	29388M	450	440	548	614	5.0	190.00	34.000
	780	206	745	576.0	74.0	199.0	100	260	9.5	6278	24650	29488M	400	592	684	8.0	407.00	83.000	
500	670	103	654	574.0	33.0	99.0	55	268	5.0	2404	12124	292/500M	470	500	578	622	4.0	101.00	16.000
	750	150	725	611.0	51.0	144.0	74	280	6.0	4216	18655	293/500M	400	613	680	5.0	220.00	46.000	
530	800	160	772	648.0	54.0	154.0	76	295	7.5	5130	22730	293/530M	380	530	651	724	6.0	286.00	64.000
600	900	180	850	731.0	64.5	171.0	87	335	7.5	6800	31500	293/600EM	330	600	735	815	6.0	390.00	120.000
630	850	132	820	724.0	42.0	127.0	67	338	6.0	4250	22500	292/630EM	350	630	730	789	5.0	211.00	44.000
800	1360	335	1300	1040.0	120.0	324.0	162	462	15.0	16340	72364	294/800M	220	800	1055	1200	12.0	2010.00	740.000