

Double Row Angular Contact Ball Bearings

d = 10 to 75 mm

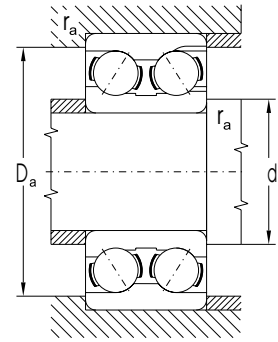
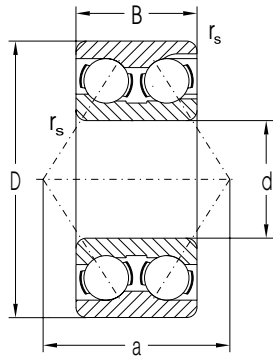

Dimensions					Basic Load Rating		Limiting Speed for Lubrication with		Bearing Designation	Abutment and Fillet Dimensions				Weight
d	D	B	r _s min	a	C _r	C _{0r}	Grease	Oil		d	d _a min	D _a max	r _a max	
mm					kN		min ⁻¹			mm				kg
10	30	14.0	0.60	20	8.410	5.840	16000	19000	3200X	10	14	25	0.6	0.0500
	30	14.3	0.60	20	8.410	5.840	16000	19000	3200		14	25	0.6	0.0500
12	32	15.9	0.60	22	10.000	7.080	14000	17000	3201	12	16	27	0.6	0.0600
	35	15.9	0.60	23	9.440	7.500	13000	16000	3202		15	19	30	0.6
15	42	19.0	1.00	27	15.800	11.900	10600	12600	3302	15	21	36	1.0	0.1300
	47	22.2	1.00	31	21.500	16.200	9400	11000	3303		17	21	35	0.6
17	47	22.2	1.00	31	21.500	16.200	9400	11000	3303	17	23	41	1.0	0.1900
	40	17.5	0.60	27	13.100	10.600	11000	13000	3203		20	25	42	1.0
20	52	22.2	1.10	34	21.500	18.500	8400	10000	3304	20	27	45	1.0	0.2300
	52	20.6	1.00	35	19.600	18.100	8400	10000	3205		25	30	46	1.0
25	62	25.4	1.10	40	29.900	26.600	7100	8400	3305	25	32	55	1.0	0.3700
	62	23.8	1.00	41	28.200	27.100	7100	8400	3206		30	35	56	1.0
30	72	30.2	1.10	47	39.800	36.200	6000	7100	3306	30	37	65	1.0	0.5800
	72	27.0	1.10	47	38.300	37.600	6000	7100	3207		35	41	65	1.0
35	80	34.9	1.50	54	51.100	47.300	5300	6300	3307	35	44	71	1.5	0.7800
	80	30.2	1.10	52	43.800	43.800	5300	6300	3208		40	46	73	1.0
40	90	36.5	1.50	58	54.000	59.600	4700	5600	3308	40	49	81	1.5	1.0500
	85	30.2	1.10	56	47.300	51.100	5000	6000	3209		45	51	78	1.0
45	100	39.7	1.50	64	75.000	73.600	4200	5000	3309	45	54	91	1.5	1.4100
	90	30.2	1.10	59	54.100	58.400	4500	5300	3210		50	56	83	1.0
50	110	44.4	2.00	73	90.900	96.200	3800	4500	3310	50	60	100	2.0	1.9000
	100	33.3	1.50	64	60.700	66.800	4200	5000	3211		55	62	91	1.5
55	120	49.2	2.00	80	100.000	108.000	3300	4000	3311	55	65	110	2.0	2.4800
	110	36.5	1.50	71	75.000	85.800	3800	4500	3212		60	67	101	1.5
60	130	54.0	2.10	86	117.000	128.000	3200	3800	3312	60	72	118	2.0	3.1700
	120	38.1	1.50	76	82.500	94.400	3500	4200	3213		65	72	111	1.5
65	140	58.7	2.10	94	133.000	147.000	3000	3500	3313	65	77	128	2.0	4.0100
	125	39.7	1.50	81	79.400	98.100	3200	3800	3214		70	77	116	1.5
70	125	39.7	1.50	81	79.400	98.100	3200	3800	3214	70	77	116	1.5	1.9300
75	130	41.3	1.50	84	87.400	110.000	3200	3800	3215	75	82	121	1.5	2.0800